

Alameda Technology Center

Office Space For Lease



1255 HARBOR BAY PARKWAY - 22,250 SQUARE FEET

- Flexible mix of private offices and open work stations
- Potential turnkey environment with phone, data and furniture
- Tenant improvements available
- Flexible term available
- Free parking 3.4/ 1,000
- Potentially 45,000 sqft by combining via adjacent 1265 Harbor Bay Parkway building
- Grade level doors
- On-site café



AEGIS





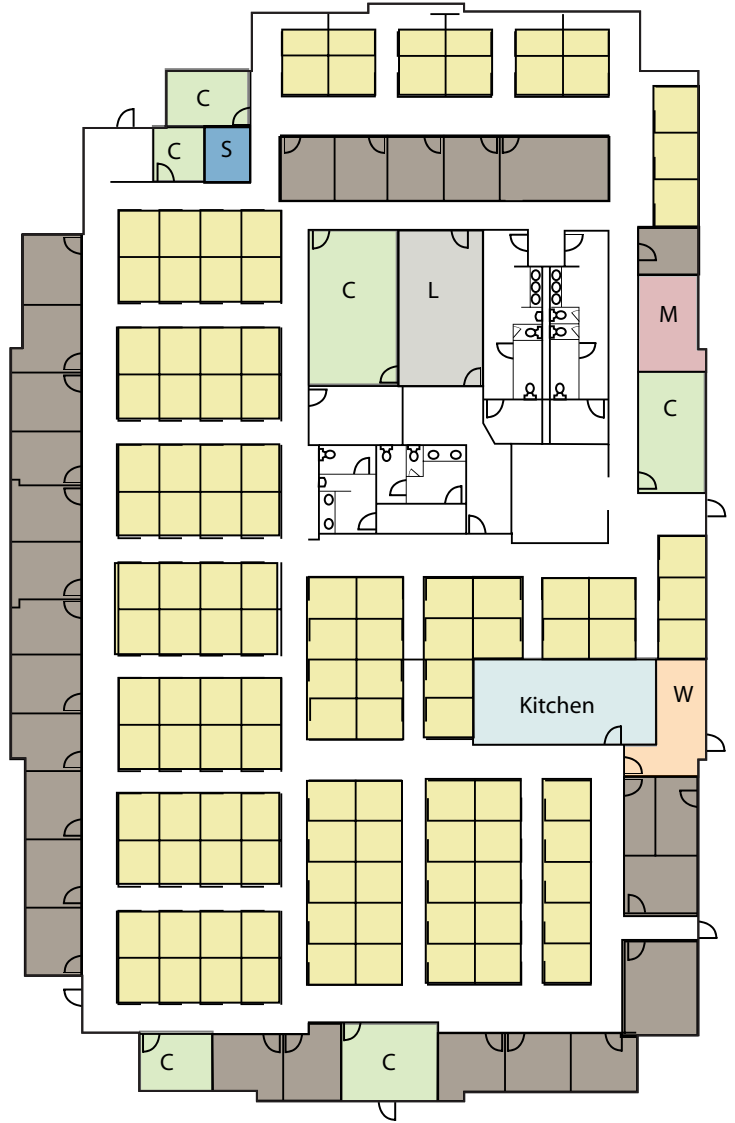

Scott Stone
Principal
(510) 273-2003
DRE # 01230051
scott@aegisrealty.com

Stephen Carlson
Associate Director
(510) 273-2005
DRE # 01839414
stephen@aegisrealty.com

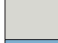

Site Plan



	C = Conference Room
	L = I.T. Lab
	S = Storage
	M = Mail Room
	W = Warehouse
	Kitchen
	Cubicles
	Private Offices

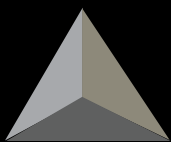

AEGIS

Scott Stone
(510) 273-2003
DRE # 01230051
scott@aegisrealty.com

Stephen Carlson
(510) 273-2005
DRE # 01839414
stephen@aegisrealty.com