

Available Short-Term
R&D and Office Lease

5741-5749 Doyle Street
5710-5780 Hollis Street

Emeryville, California



Prime Emeryville Office Space
Leases Available Through August 31, 2010

PARKSIDE BRICK BUILDING

Office Availabilities

Square Feet	Price/ sqft	Suite
2,080	\$1.25 IG	1349 Powell

PARKSIDE HOLLIS BUILDING

Office Availabilities

Square Feet	Price/ sqft	Suite
900	\$1.35 FS	5746 Hollis
1,125	\$1.35 FS	5752 Hollis
2,665	\$1.35 FS	5718 Hollis

Industrial Availabilities

Square Feet	Price/ sqft	Suite
10,000 (Storage)	\$0.35 (Basement)	5710 Hollis

Exclusively Represented By:

MATT ELMQUIST

Partner

(510) 273-2004

DRE # 01230052

Matt@aegisrealty.com

STEPHEN CARLSON

Associate Director

(510) 273-2005

DRE # 01839414

Stephen@aegisrealty.com



AEGIS

555 12th Street, Suite 110

Oakland, CA 94607

admin@aegisrealty.com

www.aegisrealty.com

Available Short-Term
R&D and Office Lease

5741-5749 Doyle Street
5710-5780 Hollis Street

Emeryville, California

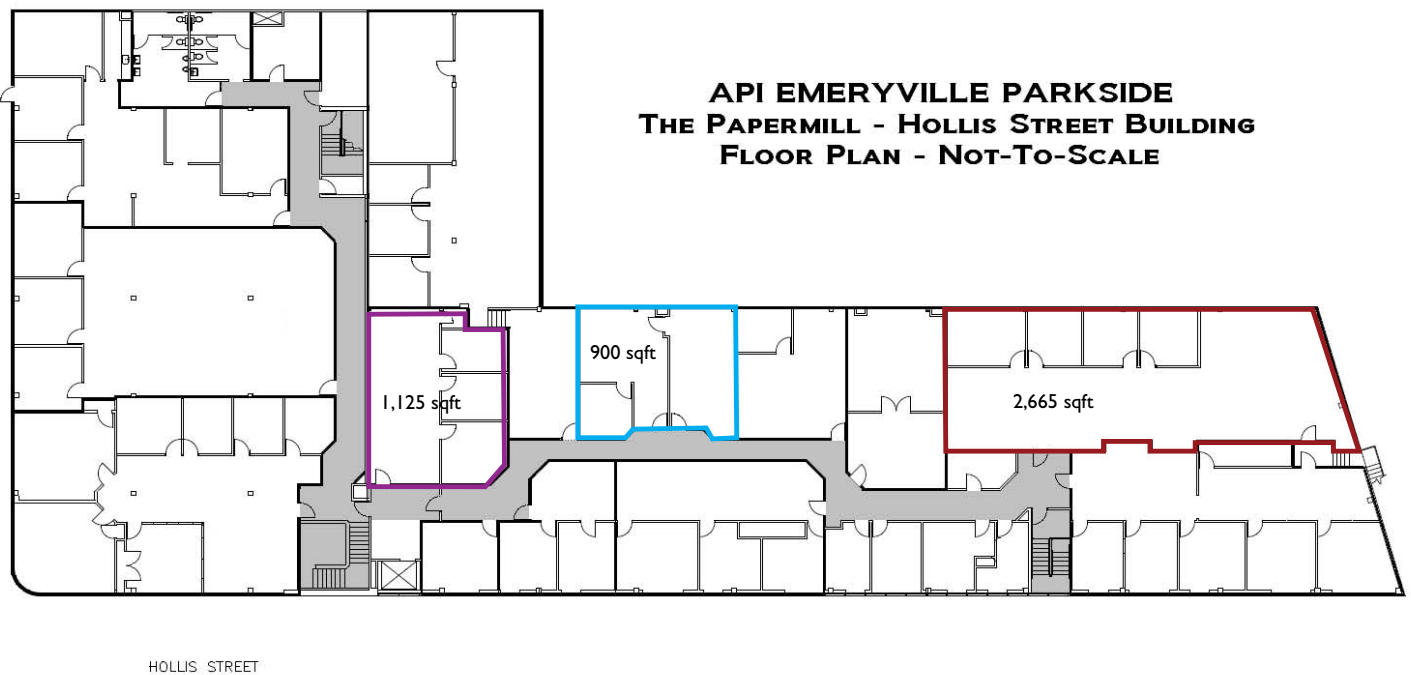

Prime Emeryville Office Space Leases Available Through August 31, 2010

- Numerous dining and retail destinations within walking distance including: Bay Street, The Public Market, Trader Joe's and multiple hotels
- Emeryville has an Amtrak station, BART Station, AC Transit, the city also runs a free shuttle service called Emery Go Round that serves MacArthur BART, the Bay Street Shops, the Marina and other places
- Emeryville is home to biotechnology, software and film industries



AEGIS

555 12th Street, Suite 110
Oakland, CA 94607
admin@aegisrealty.com
www.aegisrealty.com

Exclusively Represented by:

Matt Elmquist
Principal
510.273.2004
License # 01230052
matt@aegisrealty.com

Stephen Carlson
Associate Director
510.273.2005
License # 01839414
stephen@aegisrealty.com